

CONFIDENTIAL



JANUARY 2019

DSH201R new product release

Presentation of the new series

D. Pandolfo_ EPBP GPG DIN-Rail, Global Product Management



Agenda

- DSH201R _ Product description
- DSH201R _ Benefits for the customers

DSH201R _ Product description



Presentation of the new series

DSH201R _ Product description

DSH201R



In April 2019, a new RCBO with series name DSH201R will be released in Russia, replacing the actual range DSH941R.

DSH201R is a 1P+N RCBO in two modules width in 4.5kA breaking capacity, dedicated for Russian market for residential applications.

The series offers a complete protection against:

- Short-circuits
- Overload
- Earth fault currents

Replacement of actual DSH941R

DSH201R _ Product description



Actual DSH941R



New DSH201R

The introduction of **DSH201R** in Russia aims to replace the actual DSH941R range that is not integrated in the Compact Home Offer, in order to achieve a better aesthetical integration in the consumer unit, with a better family feeling with home ranges.

Product overview

DSH201R _ Product description

Test pushbutton

Test pushbutton to verify the correct functioning of the device, in the same position and shape of F200 one.

Blue color dedicated for Russian market.

Earth fault indicator

Blue flag on the toggle to identify earth fault trips.

I ON – 0 OFF indication molded on the toggle.

Dedicated space for label

Dedicated space to insert labels in order to clearly identify the protected lines

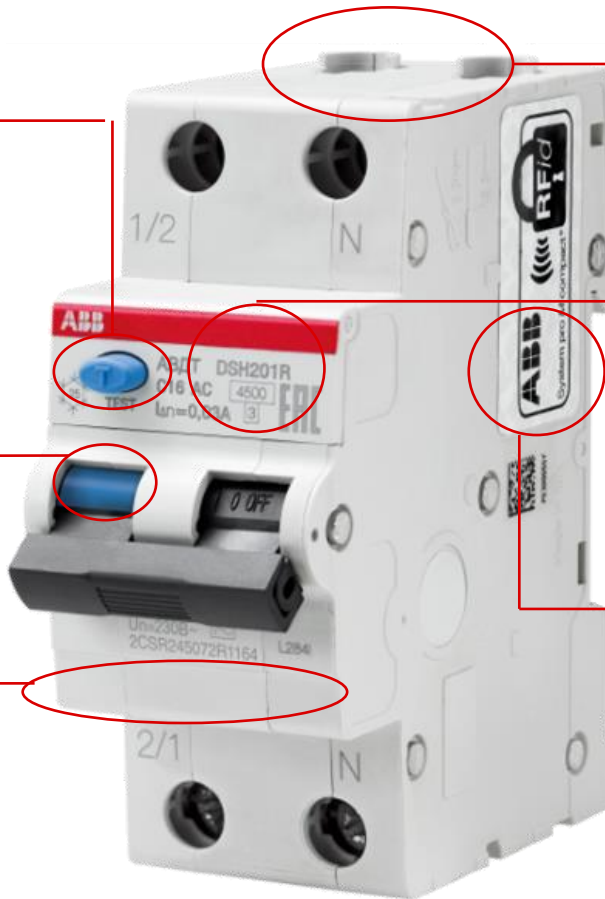

Easy to install

25 mm² cage terminals with fail safe feature to avoid improper installation.
Supply possible either from top or bottom side

Laser printed information

Information on the device are laser printed to ensure readability over time. Customized information for Russian market

Anti counterfeiting

RFid tag containing a unique serial number assigned to ABB in order to authenticate the product

Product features

DSH201R_ Product description



25 mm² aligned cage terminals with fail safe feature to avoid improper installation.
Supply possible either from top or bottom side with cables or busbars.



Main technical information and product code are laser printed on the front side, visible also when the device is installed.

Customized layout for Russian market, with indication in Cyrillic and EAC logo.

Blue test pushbutton dedicated only for Russia.
Snowflake to indicate minimum operating temperature -25°C.



Product Made in Italy, with the indication molded on the side.

Rfid tag on the product side containing a unique serial number assigned to ABB according to the standard ISO/IEC FCD 15693-3 in order to authenticate the product.

Tightening torque and stripping length of the cable molded directly on the product side

Product features

DSH201R_ Product description

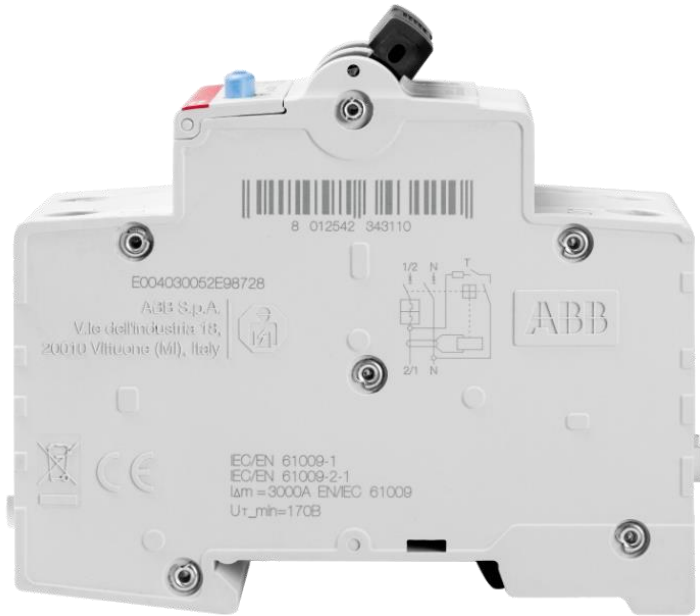

Additional information are laser printed on the lateral side of the device, including also the wiring diagram and the EAN code



Any earth fault can be immediately identified through the blue indicator, that signals the differential tripping and which cannot be activated in case of manual operation on the toggle. Easy troubleshooting and reduced downtime for maintenance operations



Dedicated packaging label customized for Russian market, with indications in Cyrillic

Layout differences within the actual range

DSH201R _ Product description

DSH941R compared to DSH201R

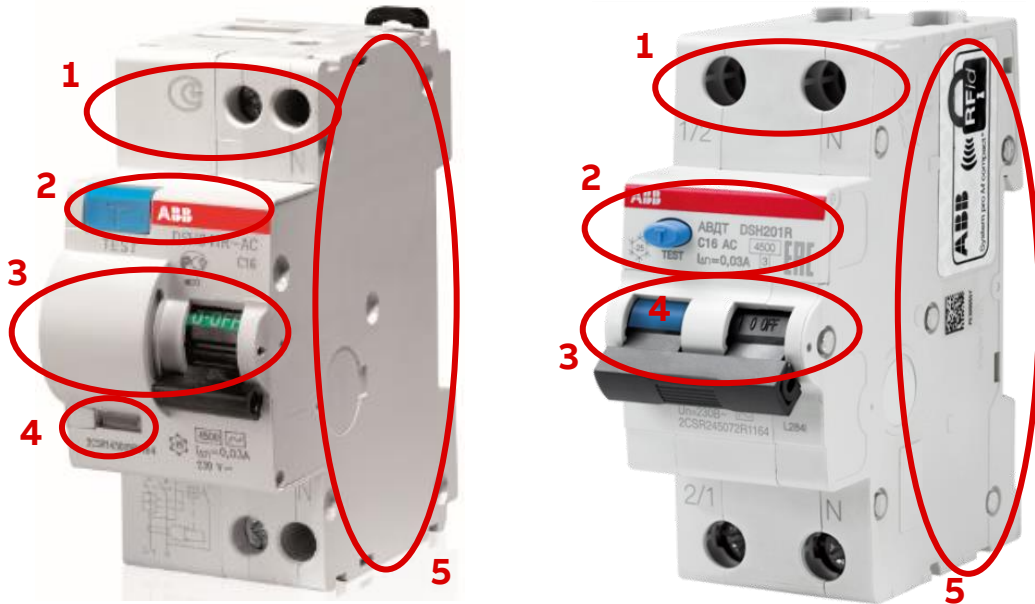

Differences description

1. Aligned cage 25mm² terminals with fail safe feature
2. Continuous red stripe as per all DIN Rail components and test pushbutton in the same position and shape of FH/F200 range. New layout of lasered information.
3. New layout with new toggle with the same shape, rotation angle and look and feel of SH/S200 range, 0 OFF/I ON indication molded on the toggle
4. Blue flag for earth fault indication on the toggle
5. Different information molded on product side and different position of tag Rfid

Relevant differences in terms of layout for an enhanced aesthetical integration in the Compact Home offer

Main technical features and comparison with DSH941R

DSH201R _ Product description

	DSH201R	DSH941R
Standards	IEC/EN 61009	IEC/EN 61009
Poles	1+N	1+N
Modules	2	2
Type	AC	AC
Sensitivity (mA)	30	30
Tripping characteristics	C	C
Rated current I _n	6,10,16,20,25,32,40	6,10,16,20,25,32,40
Breaking capacity, I _{cn} (A) acc. to IEC 61009	4500	4500
Breaking capacity, I _{cu} (A) acc. to IEC 60947-2	6000	6000
Rated residual making & breaking capacity I _{dm} (A) acc. to IEC/EN 61009	3000	3000
Rated frequency	50 Hz	50 Hz
Rated voltage	230 V	230 V
Ambient temperature (with daily average ≤ +35 °C)	-25...+55°C	-25...+55°C
Combination with accessories	No	No

Dimension and weight

DSH201R _ Product description

DSH201R

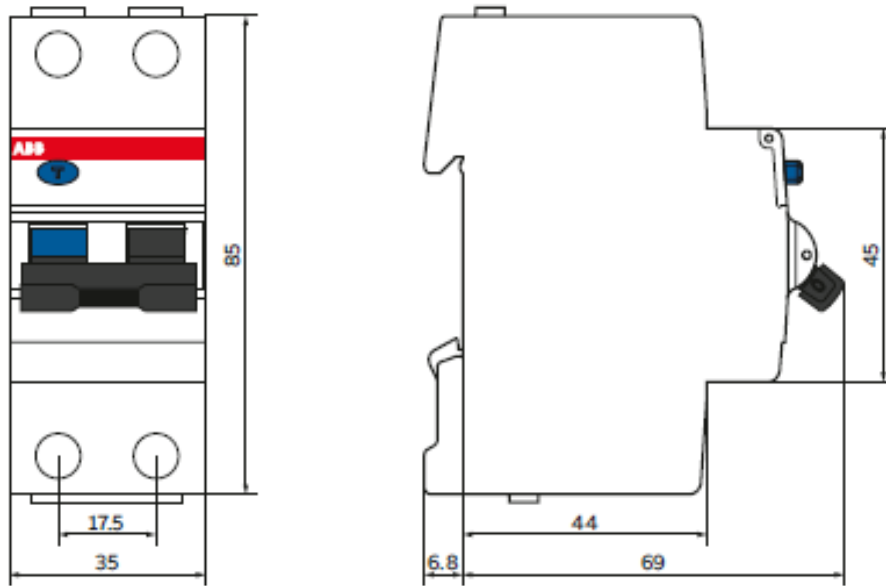

Dimension in mm

Dimensions (H x D x W)

– 85 x 69 x 35 mm

Weight

– 182 g

LCM presentation

DSH201R _ Product description

Product release expected in **April 2019** according to the below LCM table.
Introduction in RU with the dedicated announcement

	Q2 2019			Q3 2019			Q4 2019			Q1 2020		
	A	M	J	J	A	S	O	N	D	J	F	M
DSH941 R	A	A	A	C	C	C	L	L	L	O	O	O
DSH201R	A	A	A	A	A	A	A	A	A	A	A	A

Cross-reference between the old and new series and POD information are available in the attached file



DSH201R_Cross
reference and POD

Order codes

DSH201R_ Product description



DSH201R 4500 AC type, C characteristic

Number of poles	Rated residual current I Δ n mA	Rated current I _n A	Bbn 8012542	Order details		Price 1 piece	Weight 1 piece kg	Pack unit pc.
				Type code	Order code			
1+N	30	6	343318	DSH201R C6 AC30	2CSR245072R1064		0.182	1
		10	343219	DSH201R C10 AC30	2CSR245072R1104		0.182	1
		16	343110	DSH201R C16 AC30	2CSR245072R1164		0.182	1
		20	343011	DSH201R C20 AC30	2CSR245072R1204		0.182	1
		25	342915	DSH201R C25 AC30	2CSR245072R1254		0.182	1
		32	776710	DSH201R C32 AC30	2CSR245072R1324		0.182	1
		40	342816	DSH201R C40 AC30	2CSR245072R1404		0.182	1

Electrical features

DSH201R_ Product description



Standards	IEC/EN 61009-1; IEC/EN 61009-2-1		
Type (wave form of the earth leakage sensed)	AC		
Number of poles	1P + N		
Rated current I _n	A	6 ≤ I _n ≤ 40	
Rated sensitivity IΔn	A	0.03	
Rated voltage U _e	V	230	
Insulation voltage U _i	V	500 V AC	
Overvoltage category	III		
Pollution degree	2		
Operating voltage of circuit test U _t	V	170 - 254	
Rated frequency	Hz	50	
Rated breaking capacity acc. to IEC/EN 61009-1	I _{cn}	A	4500
Rated breaking capacity acc. to IEC/EN 60947-2 (only referring to short circuit test)	ultimate I _{cu}	kA	6
	service I _{cs}	kA	4.5
Rated residual breaking capacity IΔm according to EN/IEC 61009-1	A	3000	
Rated impulse withstand voltage (1.2/50) U _{imp}	kV	4 kV	
Dielectric test voltage at ind. freq. for 1 min.	kV	2.5 kV (50 / 60Hz, 1 min.)	
Thermomagnetic release characteristic	C: 5 I _n ≤ I _n ≤ 10 I _n	■	
Energy limiting class acc. to EN 61009-1	3		

Mechanical features

DSH201R _ Product description



Mechanical features	Housing	Insulation group I - II, RAL 7035
	Toggle	Insulation group II, Black RAL 9005, sealable in ON-OFF positions
	Earth fault trip indication	Blue flag on toggle
	Electrical life	operations 10000
	Mechanical life	operations 20000
	Protection degree acc. to EN 60529	housing IP4X
		terminals IP2X
	Shock resistance acc. to IEC/EN 60068-2-27	25 g - 2 shocks - 13 ms
	Vibration resistance acc. to IEC/EN 60068-2-6	0.1 mm or 1 g - 20 cycles at 5...150...5 Hz
	Environmental conditions (damp heat) acc. to IEC/EN 60068-2-30	°C/RH 28 cycles with 55 °C/90-96% and 25 °C/95-100%
Reference temperature for setting of thermal element	°C 30	
Ambient temperature (with daily average $\leq +35$ °C)	°C -25...+55	
Storage temperature	°C -40...+70	

Mounting

DSH201R _ Product description



Terminal type	top / bottom		cage terminal with integrated failsafe
Terminal size for cables	top / bottom	mm ²	25/25
Tightening torque	top / bottom	Nm	2
Stripping length of the cable		mm	12.5
Mounting			on DIN rail EN 60715 (35 mm) by means of mounting clip
Mounting position			Any
Supply from			Top/Bottom terminals

Instructions

DSH201R _ Product description

DSH201R instructions

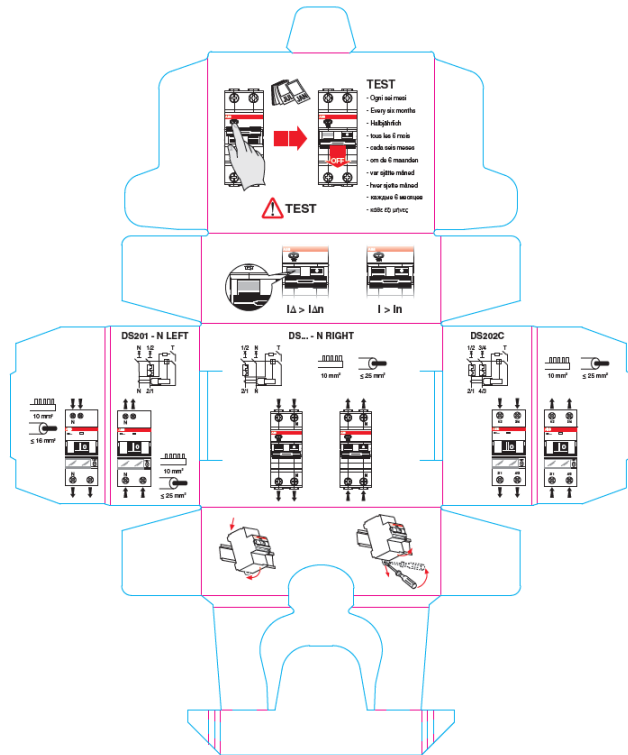

Eco friendly Instruction printed directly inside the packaging, avoiding additional instruction sheet.

Instructions are general, combining different RCBOs series.

DSH201R _ Benefits for the customers



Benefits for panel builders

DSH201R _ Benefits for the customers

Family feeling

- Complete integration in the distribution board with other Compact Home devices for an enhanced family feeling

Easy to install

- Possibility to install the product using cables or ABB PSH busbars in only one step. Combination also possible with PS busbars.
- Supply possible from top and bottom terminals
- Stable fixing on DIN rail, easy and fast mounting and dismounting operations thanks to the standard mounting clip

Continuous operation

- Easier troubleshooting on the network and reduced downtime for maintenance operations thanks to the earth fault indicator (blue flag on the toggle)

Benefits for wholesalers

DSH201R _ Benefits for the customers

Family feeling

- Complete integration in the distribution board with other Compact Home devices for an enhanced family feeling

Optimized logistic

Stock reduction due to:

- Limited number of codes, in order to cover main customer needs for residential applications
- ABB PSH (or PS) busbars can be used for the connection of the device

Benefits for consultants

DSH201R _ Benefits for the customers

For the consultant

Possibility to consult and have access to:

- Full technical data
- Complete back-up and selectivity tables (availability in April)
- Derating values according to the temperature

Benefits for LSU

DSH201R _ Benefits for the customers

New business opportunities

- Growing the revenues on the new product range
- Effective possibility to have a Compact Home offer integrated also with RCBOs

Customer support

- Product manufactured in Santa Palomba factory, available for customer visits.
- Availability of full technical data for support customers' request

ABB